

Rockton Hydroelectric Project
FERC Project No. 2373

Dixon Hydroelectric Project
FERC Project No. 2446

**Applications for a Subsequent License for a Minor Water Power
Project Less than 1.5 Megawatts**

and

**A New License for a Major Water Power Project Less than 5
Megawatts**

Prepared for

Midwest Hydro, LLC and STS Hydropower, LLC
Neshkoro, WI

Prepared by



meadhunt.com

Volume 2 of 4
Exhibits F and G

Volume 2 of 4
Exhibits F and G

| | Page |
|--|-------------|
| Rockton Exhibit F – General Design Drawings of Project Works | FR-1 |
| Dixon Exhibit F – General Design Drawings of Project Works | FD-1 |
| Rockton Exhibit G – Project Boundary Maps..... | GR-1 |
| Dixon Exhibit G – Project Boundary Maps..... | GD-1 |

**Rockton Hydroelectric Project
FERC Project No. 2373**

**Exhibit F
General Design Drawings of Project Works**

Draft License Application

Prepared for

Midwest Hydro, LLC

Prepared by



March 2022

TABLE OF CONTENTS

- 1. Rockton Hydroelectric Project – Plan of Control Works**
- 2. Rockton Hydroelectric Project – Section Through Control Works and Overflow Dam**
- 3. Rockton Hydroelectric Project – Upstream Elevation of Control Works**
- 4. Rockton Hydroelectric Project – Downstream Elevation of Powerhouse**
- 5. Rockton Hydroelectric Project – End Elevation of Powerhouse**
- 6. Rockton Hydroelectric Project – Sectional Elevation of Powerhouse**
- 7. Rockton Hydroelectric Project – Sectional Elevation of Powerhouse**
- 8. Rockton Hydroelectric Project – Plan of Generator Floor**
- 9. Rockton Hydroelectric Project – Power Canal and Sections**

Rockton Exhibit F
has been E-filed separately as
Critical Energy Infrastructure Information

**Dixon Hydroelectric Project
FERC Project No. 2446**

**Exhibit F
General Design Drawings of Project Works**

Draft License Application

Prepared for

STS Hydropower, LLC

Prepared by



March 2022

TABLE OF CONTENTS

- 1. Dixon Hydroelectric Project – Overall Project Plan**
- 2. Dixon Hydroelectric Project – Powerhouse Plan, Elevation, and Section**
- 3. Dixon Hydroelectric Project – Spillway, Forebay Wall, Fender Wall Elevation and Sections**

Dixon Exhibit F
has been E-filed separately as
Critical Energy Infrastructure Information

**Rockton Hydroelectric Project
FERC Project No. 2373**

**Exhibit G
Project Boundary Maps**

Draft License Application

Prepared for

Midwest Hydro, LLC

Prepared by



March 2022

TABLE OF CONTENTS

- 1. Rockton Project Boundary Map G-1**
- 2. Rockton Project Boundary Map G-2 (Land Ownership, Course, & Recreation Site Tables)**

I HEREBY STATE THE PROJECT BOUNDARY DELINEATION FOR THE ROCKTON HYDROELECTRIC PROJECT AS SHOWN ON THIS EXHIBIT "G" MAP IS DEVELOPED WITHIN REASONABLE MAPPING ACCURACIES AS REQUIRED IN 18CFR4.1. THE DOCUMENTED ROCKTON PROJECT BOUNDARY LINE WAS ADJUSTED OR ROTATED TO BEST FIT WITH GEOSPATIAL DATA OBTAINED FROM ILLINOIS ON-LINE DATA SOURCES AND WAS NOT FIELD SURVEYED.



JASON NESS DATE

I have reviewed the Rockton Hydroelectric Project boundary shown herein. The licensee either owns in fee simple or has the rights necessary or appropriate for the operation of the hydroelectric project. Project boundary lines that are not contour lines were based on:

1. GIS parcel information provided by WinGIS for Winnebago County and Illinois Public Land Survey System (PLSS) information provided by the Illinois State Geological Survey Prairie Research Institute, or
2. meets and bounds description contained herein.

| | |
|-----------|------|
| DAVID FOX | DATE |
|-----------|------|

Metes and bounds project boundary description is based on GIS information. When the project boundary description references a specific corner, that reference shall govern over bearing and distance references in case of conflict.

Unless specifically noted otherwise, Illinois section lines are from the Illinois Public Land Survey System; parcel, right-of-way, road, and hydro boundaries are from WinGIS; and river flowline is from the USGS National Hydrography Dataset. Contour lines generated from LiDAR are from the IGS Winnebago County Project 2018. These items have not been surveyed by Mead & Hunt, Inc.

ALL PUBLIC ROADS AND ASSOCIATED RIGHTS-OF-WAYS
ARE EXCLUDED FROM THE PROJECT.

Common Section Corner
Sections 11, 12, 13, 14
T46N R1E

X: 2,588,710.19
Y: 2,114,276.09

PROJECT BOUNDARY
(Contour elevation
725.48 ft NGVD29)

PROJECT BOUNDARY
— (Contour elevation
725.48 ft NGVD29)

X: 2,594,213.15
Y: 2,114,631.12

er

Common Section Corner
Sections 13, 14, 23, 24
T46N R1E

BOUNDARY
elevation

NGVD29)

X: 2,593,006.05
Y: 2,109,021.65

ROCKTON, ILLINOIS

**ROCKTON
HYDROELECTRIC PROJECT
FERC PROJECT No. 2373
ROCK RIVER, WINNEBAGO COUNTY, ILLINOIS
PROJECT BOUNDARY MAP**

Mead
& Hunt

SCALE: AS SHOWN
DATE: MAR 2022

GR-1

P-2373-XXX

NUMBERED PARCEL LAND OWNERSHIP TABLE

| MAP ID | PARCEL ID | OWNER | OWNERSHIP TYPE |
|--------|---------------|---|----------------|
| 1 | 03-24-108-002 | MIDWEST HYDRO INC | LICENSEE |
| 2 | 03-24-108-003 | MIDWEST HYDRO INC | LICENSEE |
| 3 | 03-24-176-002 | VILLAGE OF ROCKTON ILLINOIS | VILLAGE |
| 4 | 03-14-452-003 | MIDWEST HYDRO INC | LICENSEE |
| 5 | 03-14-452-003 | MIDWEST HYDRO INC | LICENSEE |
| 6 | 03-14-476-001 | RANDY DOUGLAS & SUE ANN PALM | PRIVATE |
| 7 | 03-14-428-003 | ROCKTON TOWNSHIP CEMETERY | TOWNSHIP |
| 8 | 03-14-428-002 | ROCKTON TOWNSHIP | TOWNSHIP |
| 9 | 03-14-428-001 | NORTH AMERICAN HYDRO INC | LICENSEE |
| 10 | 03-13-351-003 | ROCKTON TOWNSHIP | TOWNSHIP |
| 11 | 03-13-352-010 | MATTHEW D & ALYSSA M HALL | PRIVATE |
| 12 | 03-13-352-002 | DIANA WILLIAMS | PRIVATE |
| 13 | 03-13-352-003 | ROCKTON BOAT CLUB INC | PRIVATE |
| 14 | 03-13-302-004 | GREG & SHARON CROWLEY | PRIVATE |
| 15 | 03-13-302-003 | BRUCE D & MARY ANNE MATHWICH | PRIVATE |
| 16 | 03-13-302-018 | MICHAEL J & SUSANNE M PISANO | PRIVATE |
| 17 | 03-13-302-019 | PATRICIA DAVEY | PRIVATE |
| 18 | 03-13-326-007 | RONALD L & MARJORIE BROWN | PRIVATE |
| 19 | 03-13-326-006 | RONALD L & MARJORIE BROWN | PRIVATE |
| 20 | 03-13-326-005 | FRED BLACK | PRIVATE |
| 21 | 03-13-326-004 | GREGORY S & ERIN A KLADAR | PRIVATE |
| 22 | 03-13-326-003 | BARBARA M TRUSTEE & RICHARD J CALVETTE | PRIVATE |
| 23 | 03-13-326-002 | ANTHONY J & KRISTINA M SCHAEFFER | PRIVATE |
| 24 | 03-13-326-001 | MICHAEL D & ROXANN ARMSTRONG | PRIVATE |
| 25 | 03-13-177-010 | MICHAEL D & ROXANN ARMSTRONG | PRIVATE |
| 26 | 03-13-177-009 | SHELBY BOGDAN | PRIVATE |
| 27 | 03-13-177-008 | JOSEMINA BAUN & WARREN L HICKMAN | PRIVATE |
| 28 | 03-13-177-004 | KYLE NICHOLAS KRICK | PRIVATE |
| 29 | 03-13-177-003 | MARK & NICOLE ALCORN | PRIVATE |
| 30 | 03-13-177-002 | THOMAS M & MARY K PETERSON | PRIVATE |
| 31 | 03-13-126-001 | LUBRIZOL HOLDING INC | PRIVATE |
| 32 | 03-13-176-010 | CODY E & LUISA DINUNZIO MIRARCHI WRIGHT | PRIVATE |
| 33 | 03-13-151-002 | WINNEBAGO CO FOREST PRESERVE DISTRICT | COUNTY |
| 34 | 03-13-151-003 | MIDWEST HYDRO INC | LICENSEE |

RECREATION SITE TABLE

| Site ID | Recreation Facility | Latitude | Longitude |
|---------|--|-------------------|-------------------|
| 1 | Rockton Tailrace Bank Fishing Area | 42° 27' 04.079" N | 89° 04' 31.205" W |
| 2 | Rockton Dam Canoe Portage | 42° 27' 37.089" N | 89° 04' 41.077" W |
| 3 | Rockton Overflow Dam and Power Canal Bank Fishing Area | 42° 27' 35.593" N | 89° 04' 54.907" W |

PROJECT BOUNDARY COURSE TABLE

| From Point | To Point | Distance (feet) | Bearing | Description |
|----------------------------------|----------|-----------------|-------------|---|
| NW Corner | A | 1,166.69 | S00°04'51"E | From NW corner Section 24, T46N, R1E to Point A |
| A | 1 (POB) | 191.34 | N89°13'30"E | |
| 1 (POB) | 2 | 443.64 | S46°03'50"E | |
| 2 | 3 | 385.88 | S41°08'33"E | |
| 3 | 4 | 157.91 | S00°00'27"E | |
| 4 | 5 | 182.19 | S78°28'43"E | |
| 5 | 6 | 159.19 | N56°29'03"E | |
| 6 | 7 | 2,753.09 | | Along parcel boundary of Parcels 2, 3, and 4 to a point at elevation contour 725.48 NGVD29 |
| 7 | 8 | 261.02 | | Along elevation contour 725.48 NGVD29 to Point 8 |
| 8 | 9 | 738.91 | | Along parcel boundary of Parcels 5 and 6 to a point at elevation contour 725.48 NGVD29 |
| 9 | 10 | 557.96 | | Along elevation contour 725.48 NGVD29 to Point 10 |
| 10 | 11 | 1,071.56 | | Along parcel boundary of Parcels 37, 38, 8, and 9 to a point at elevation contour 725.48 NGVD29 |
| 11 | 12 | 19,202.83 | | Along elevation contour 725.48 NGVD29 to Point 12 |
| Metes and bounds to arrive at 12 | | | | |
| NE Corner | B | 2,054.08 | S00°45'34"E | From NE corner Section 14, T46N, R1E to Point B |
| B | 12 | 77.24 | S89°02'26"W | |
| 12 | 13 | 83.86 | N12°10'26"W | |
| 13 | 14 | 68.02 | S80°23'43"W | |
| 14 | 15 | 1,546.00 | S12°10'27"E | |
| 15 | 16 | 110.71 | S84°19'13"W | |
| 16 | 17 | 33.90 | S12°10'27"E | |
| 17 | 18 | 71.53 | N88°47'26"E | |
| 18 | 19 | 222.97 | S36°55'59"W | |
| 19 | 20 | 712.67 | N73°22'54"W | |
| 20 | 21 | 117.91 | S52°12'14"W | |
| 21 | 22 | 214.48 | S31°45'25"W | |
| 22 | 23 | 1,079.99 | | Along parcel boundary of Parcels 36 and 37 to SW corner of Parcel 37 |
| 23 | 24 | 105.46 | | Across Parcel 38, from SW corner of Parcel 37 to NW corner of Parcel 5 |
| 24 | 25 | 818.06 | | Along parcel boundary of Parcels 5 and 39 to SE corner of Parcel 39 |
| 25 | 26 | 88.61 | | Across W Rockton Rd Right-of-Way, from SE corner of Parcel 39 to NE-most corner of Parcel 41 |
| 26 | 27 | 142.98 | | Along parcel boundary of Parcels 4, 40, and 41 to Point 27 |
| Metes and bounds to arrive at 27 | | | | |
| NE Corner | C | 923.08 | S88°14'08"W | From NE corner Section 23, T46N, R1E to Point C |
| C | 27 | 223.83 | S00°04'51"E | |
| 27 | 28 | 29.00 | S37°51'27"W | |
| 28 | 29 | 135.86 | S57°11'17"E | |
| 29 | 30 | 17.05 | N37°51'30"E | |
| 30 | 1 (POB) | 1,306.01 | | Along parcel boundary of Parcels 4, 41, 1, and 42 to Point 1 (POB) |

SURVEYOR'S STATEMENT

I HEREBY STATE THE PROJECT BOUNDARY DELINEATION FOR THE ROCKTON HYDROELECTRIC PROJECT AS SHOWN ON THIS EXHIBIT "G" MAP IS DEVELOPED WITHIN REASONABLE MAPPING ACCURACIES AS REQUIRED IN 18CFR4.41. THE DOCUMENTED ROCKTON PROJECT BOUNDARY LINE WAS ADJUSTED OR ROTATED TO BEST FIT WITH GEOSPATIAL DATA OBTAINED FROM ILLINOIS ON-LINE DATA SOURCES AND WAS NOT FIELD SURVEYED.

JASON NESS

2-3-22

DATE

REGISTERED PROFESSIONAL LAND SURVEYOR

JASON NESS

LS-6884

DATE 2-3-22

NORTH DAKOTA

LICENSEE STATEMENT

I have reviewed the Rockton Hydroelectric Project boundary shown herein. The licensee either owns in fee simple or has the rights necessary or appropriate for the operation of the hydroelectric project. Project boundary lines that are not contour lines were based on:
1. GIS parcel information provided by WinGIS for Winnebago County and Illinois Public Land Survey System (PLSS) information provided by the Illinois State Geological Survey Prairie Research Institute, or
2. metes and bounds description contained herein.

DAVID FOX

DATE

Map Note:

Metes and bounds project boundary description is based on GIS information. When the project boundary description references a specific corner, that reference shall govern over bearing and distance references in case of conflict.

Unless specifically noted otherwise, Illinois section lines are from the Illinois Public Land Survey System; parcel, right-of-way, road, and hydro boundaries are from WinGIS; and river flowline is from the USGS National Hydrography Dataset. Contour lines generated from LIDAR are from the iSGS Winnebago County Project 2018. These items have not been surveyed by Mead & Hunt, Inc.

ALL PUBLIC ROADS AND ASSOCIATED RIGHTS-OF-WAYS ARE EXCLUDED FROM THE PROJECT.

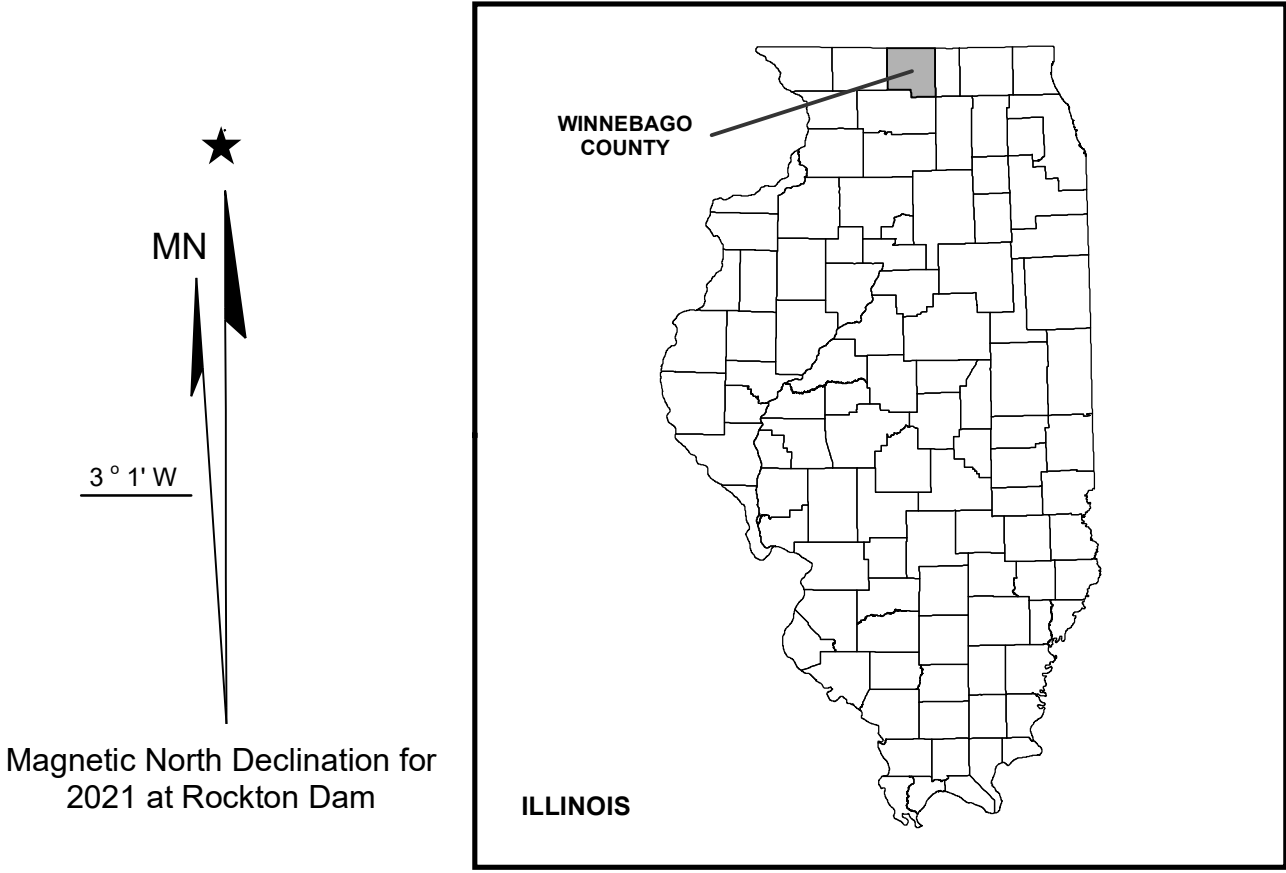

Reference coordinates are in Illinois Stateplane
West Zone FIPS 1202, NAD83 (2011).
Coordinate units are in U. S. Survey feet.
Project boundary elevation contour is referenced to NGVD 1929.

MIDWEST HYDRO, LLC

ROCKTON, ILLINOIS

ROCKTON

HYDROELECTRIC PROJECT

FERC PROJECT No. 2373

ROCK RIVER, WINNEBAGO COUNTY, ILLINOIS

PROJECT BOUNDARY MAP

Mead & Hunt

SCALE: AS SHOWN
DATE: MAR 2022

**Dixon Hydroelectric Project
FERC Project No. 2446**

**Exhibit G
Project Boundary Maps**

Draft License Application

Prepared for

STS Hydropower, LLC

Prepared by



March 2022

TABLE OF CONTENTS

- 1. Dixon Project Boundary Map G-1**
- 2. Dixon Project Boundary Map G-2 (Land Ownership, Course, & Recreation Site Tables)**

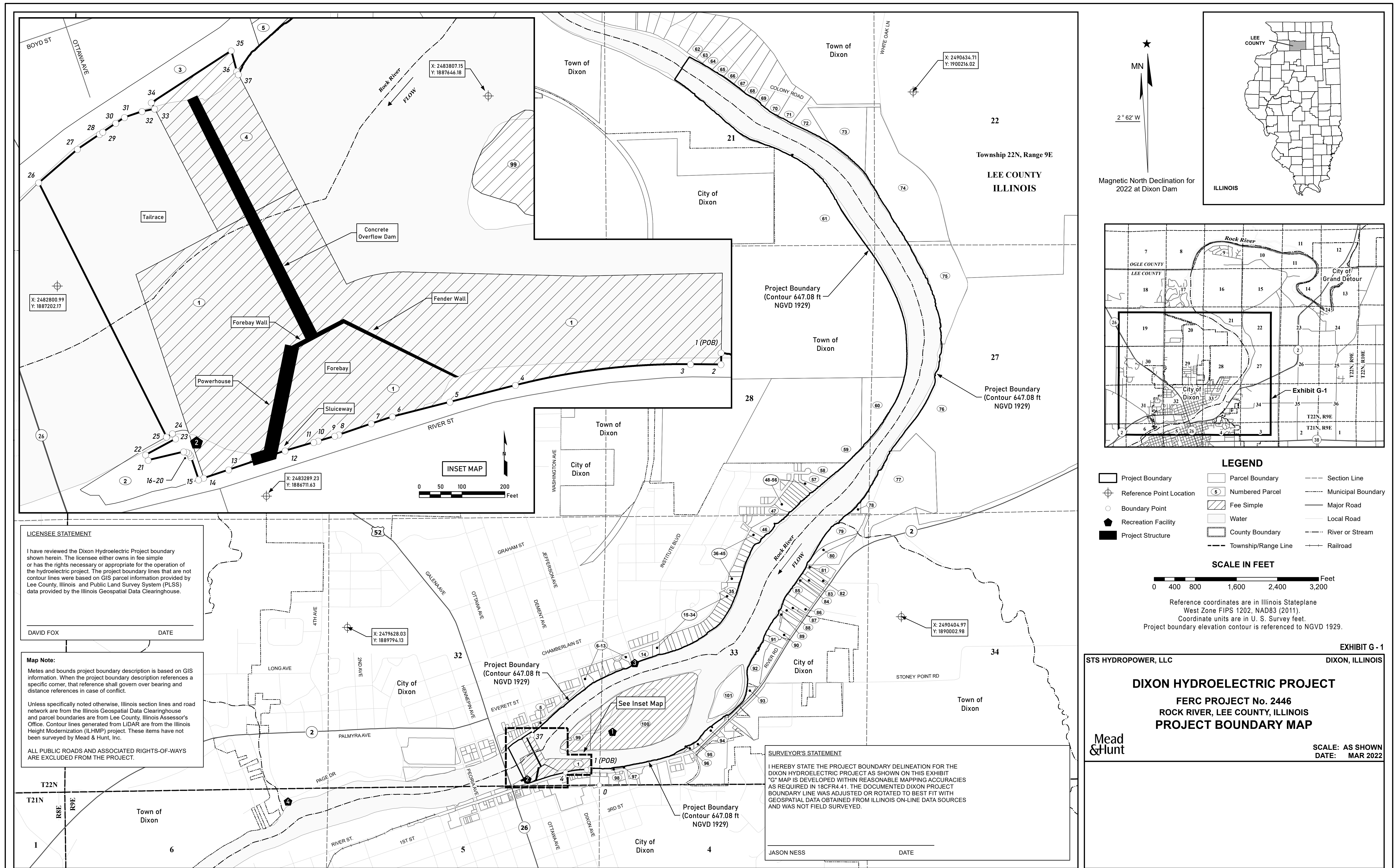

NUMBERED PARCEL LAND OWNERSHIP TABLE

| MAP ID | PARCEL ID | OWNER | OWNERSHIP TYPE |
|--------|-------------|--|----------------|
| 1 | 70232478001 | STS HYDROPOWER LTD | LICENSEE |
| 2 | 70232478002 | DIXON CITY OF | PUBLIC |
| 3 | 70232460020 | DIXON PARK DISTRICT | PUBLIC |
| 4 | 70232461006 | STS HYDROPOWER LTD | LICENSEE |
| 5 | 70232476003 | DIXON PARK DISTRICT | PUBLIC |
| 6 | 70232435006 | SIMPSON ERIC E & HOLTON-SIMPSON KIMBERLY L | PRIVATE |
| 7 | 70233302012 | DIMMIG TROY D & TAMMY TUPPER | PRIVATE |
| 8 | 70233302003 | HOFMANN FAMILY TRUST | PRIVATE |
| 9 | 70233302004 | MOSS THEODORE L & MOSS GROVER Z | PRIVATE |
| 10 | 70233302005 | BERGEMANN ERIC | PRIVATE |
| 11 | 70233302010 | DEETS DAVID K & JAN M | PRIVATE |
| 12 | 70233302011 | MCCLAIN NATHAN A & CALLI JO | PRIVATE |
| 13 | 70233302008 | NEISEWANDER TRUST TODD | PRIVATE |
| 14 | 70233304003 | CHERYL A MARSHALL TRUST DATED 6/8/2010 CHERYL A MARSHALL TRUSTEE | PRIVATE |
| 15 | 70233180002 | CURIA JAMIER | PRIVATE |
| 16 | 70233180003 | RADANDT 2014 IRREVOCABLE INCOME ONLY TRUST JACQUELINE ANN | PRIVATE |
| 17 | 70233180004 | SAUK VALLEY BANK & TRUST CO., TRUSTEE TRUST #855SVLT013 | PRIVATE |
| 18 | 70233180005 | MARSHALL JESSIA | PRIVATE |
| 19 | 70233180006 | CURIA AMANDA J & JONATHAN T HINKEY | PRIVATE |
| 20 | 70233180007 | MARSHALL FAMILY 1112 LAND TRUST | PRIVATE |
| 21 | 70233180025 | HERTENSTEIN TRUST SARAA & THOMPSON TRUST JAN J | PRIVATE |
| 22 | 70233180026 | CRISHAM FAMILY TRUST | PRIVATE |
| 23 | 70233180011 | JULIN RHONDA L & JULIN RONALD | PRIVATE |
| 24 | 70233180012 | GLASER MARJORIE ANN | PRIVATE |
| 25 | 70233180013 | FISCHER SHIRLEY | PRIVATE |
| 26 | 70233180014 | NELSON KAREN | PRIVATE |
| 27 | 70233180015 | NAGY JOHN & DEBRA | PRIVATE |
| 28 | 70233180016 | YOUNT KATHRYN E | PRIVATE |
| 29 | 70233180017 | PIPER RYBAK LIVING TRUST DIANNE | PRIVATE |
| 30 | 70233180018 | SHAW J PETER & JAMIE | PRIVATE |
| 31 | 70233180019 | MILLER TRUST JOSEPH L | PRIVATE |
| 32 | 70233180020 | BURGER JOANNA I AND JEFFREY I | PRIVATE |
| 33 | 70233180021 | DILLABOUGH ANTHONY | PRIVATE |
| 34 | 70233180022 | CLEMENS ALAN D & AMY JO | PRIVATE |
| 35 | 70233205012 | JOHNSON TRUST ARTHUR E | PRIVATE |
| 36 | 70233205011 | FORD EDWARD R & LAURA P | PRIVATE |
| 37 | 70233205010 | HAZELWOOD CHRISTOPHER & DEBORAH | PRIVATE |
| 38 | 70233205009 | ATKINSON MITCHELL L | PRIVATE |
| 39 | 70233205008 | NICHOLS NANCY A | PRIVATE |
| 40 | 70233205007 | THOMPSON ROBERT J & THOMPSON MICHELLE M | PRIVATE |
| 41 | 70233205014 | SHAW ANDREW J & ANGELA G | PRIVATE |
| 42 | 70233205013 | TRUST 65 777 | PRIVATE |
| 43 | 70233205004 | MC FETRIDGE JANE M & MC LEAN DONALD | PRIVATE |
| 44 | 70233205003 | LESAGE TRUST JOAN M | PRIVATE |
| 45 | 70233205002 | OVERCASH KAREN L | PRIVATE |
| 46 | 70233205001 | KASTNER JASON & KAREY | PRIVATE |
| 47 | 70228456010 | HAMPTON BROTHERS INC | PRIVATE |
| 48 | 70228456011 | HAMPTON BROTHERS INC | PRIVATE |
| 49 | 70228456012 | HAMPTON BROTHERS INC | PRIVATE |
| 50 | 70228456013 | HAMPTON BROTHERS INC | PRIVATE |
| 51 | 70228456014 | HAMPTON BROTHERS INC | PRIVATE |
| 52 | 70228456015 | HAMPTON BROTHERS INC | PRIVATE |
| 53 | 70228456016 | HAMPTON BROTHERS INC | PRIVATE |
| 54 | 70228456017 | HAMPTON BROTHERS INC | PRIVATE |
| 55 | 70228456019 | HAMPTON BROTHERS INC | PRIVATE |
| 56 | 70228456018 | HAMPTON BROTHERS INC | PRIVATE |
| 57 | 70228456020 | HAMPTON BROTHERS INC | PRIVATE |
| 58 | 70228456021 | HAMPTON BROTHERS INC | PRIVATE |
| 59 | 70228401001 | KELLER BRUCE E | PRIVATE |
| 60 | 70227300001 | KELLER BRUCE E | PRIVATE |
| 61 | 70228200004 | DIXON PARK DISTRICT | PUBLIC |
| 62 | 70221100010 | GILKEY CHARLES C & GILKEY PATRICIA L | PRIVATE |
| 63 | 70221100011 | FRIEMOTH SANDRA KAY | PRIVATE |
| 64 | 70221100012 | UNDERHILE TRUST SANDRA KAY | PRIVATE |
| 65 | 70221200005 | STEVENS ROBERT D & STEVENS GERALDINE A | PRIVATE |
| 66 | 70221200006 | STEVENS ROBERT D & STEVENS GERALDINE A | PRIVATE |
| 67 | 70221200007 | SHEFFLER JERRY L & JILL R JR | PRIVATE |
| 68 | 70221200008 | SCHIER ARLYN & SCHIER KATHLEEN | PRIVATE |
| 69 | 70221200009 | BLACKBURN DARLA | PRIVATE |
| 70 | 70221200010 | WADSWORTH DARCY & WADSWORTH SANDRA A | PRIVATE |
| 71 | 70221200011 | GAVINO FLORDELIZA | PRIVATE |
| 72 | 70221200012 | GILKEY CHARLES | PRIVATE |
| 73 | 70221400001 | SCHMIDT TRUST GLENDA M | PRIVATE |
| 74 | 70222300001 | SCHMIDT TRUST GLENDA M | PRIVATE |
| 75 | 70227100002 | SCHMIDT TRUST GLENDA M | PRIVATE |
| 76 | 70227200007 | SOUTHFIELD CORPORATION | PRIVATE |
| 77 | 70227300009 | ST. BARBARA CEMENT INC. | PRIVATE |
| 78 | UNKNOWN | | UNKNOWN |
| 79 | 70233226002 | ST. BARBARA CEMENT INC. | PRIVATE |
| 80 | UNKNOWN | | UNKNOWN |
| 81 | UNKNOWN | | UNKNOWN |
| 82 | 70233227031 | GURLEY SHERRY F & GURLEY RONALD R | PRIVATE |
| 83 | 70233227030 | BUTLER STEVEN L & BUTLER ROBIN A | PRIVATE |
| 84 | UNKNOWN | | UNKNOWN |
| 85 | 70233227027 | COMMONS JOHN W & COMMONS PATSYA | PRIVATE |
| 86 | 70233227029 | DBS PROPERTIES LTD | PRIVATE |
| 87 | 70233227028 | SHIPPERT EDWARD & SHIPPERT DAWN | PRIVATE |
| 88 | 70233227033 | DONALDSON EDWARD M | PRIVATE |
| 89 | 70233252013 | KONING TRUST MATTHEW D | PRIVATE |
| 90 | 70233252011 | HALL ALICIA K & HALL WILLIAM C | PRIVATE |
| 91 | 70233252012 | ULLRICH LEON W | PRIVATE |
| 92 | 70233402008 | RAYNOR MANUFACTURING CO | PRIVATE |
| 93 | UNKNOWN | | UNKNOWN |
| 94 | 70233379002 | UNKNOWN OWNER | UNKNOWN |
| 95 | 70233379001 | UNKNOWN OWNER | UNKNOWN |
| 96 | 70233351003 | STS HYDROPOWER LTD | LICENSEE |
| 97 | 70233352014 | WARNER H C | PRIVATE |
| 98 | 70233352028 | DARK LAND TRUST #1 | PRIVATE |
| 99 | 70232477001 | STS HYDROPOWER LTD | LICENSEE |
| 100 | 70233351003 | STS HYDROPOWER LTD | LICENSEE |
| 101 | 70233326001 | DIXON PARK DISTRICT | PUBLIC |

PROJECT BOUNDARY COURSE TABLE

| From Point | To Point | Distance (feet) | Bearing | Radius (feet) | Chord Distance (feet) | Description |
|------------|----------|-----------------|-------------|---------------|-----------------------|--|
| 0 | 1 (POB) | 372.90 | N28°48'18"W | | | From NW corner Section 04, T21N, R09E to 1 (POB) |
| 1 (POB) | 2 | 27.06 | S00°46'11"W | | | Along parcel line |
| 2 | 3 | 70.94 | N89°22'44"W | | | Along parcel line |
| 3 | 4 | | S83°09'50"W | 413.25 | 412.08 | Curve along parcel line |
| 4 | 5 | 157.86 | S75°42'16"W | | | Along parcel line |
| 5 | 6 | 138.59 | S75°42'17"W | | | Along parcel line |
| 6 | 7 | 52.08 | S71°47'04"W | | | Along parcel line |
| 7 | 8 | 80.14 | S70°55'31"W | | | Along parcel line |
| 8 | 9 | 9.99 | S70°56'50"W | | | Along parcel line |
| 9 | 10 | 40.01 | S73°41'04"W | | | Along parcel line |
| 10 | 11 | 10.99 | S73°40'34"W | | | Along parcel line |
| 11 | 12 | 70.02 | S73°41'07"W | | | Along parcel line |
| 12 | 13 | 138.99 | S71°22'47"W | | | Along parcel line |
| 13 | 14 | 61.59 | S71°22'25"W | | | Along parcel line |
| 14 | 15 | 12.62 | S71°22'49"W | | | Along parcel line |
| 15 | 16 | 55.72 | N18°24'31"W | | | |
| 16 | 17 | 5.37 | N22°41'03"W | | | |
| 17 | 18 | 5.64 | N37°38'50"W | | | |
| 18 | 19 | 5.36 | N64°39'10"W | | | |
| 19 | 20 | 6.63 | N80°31'47"W | | | |
| 20 | 21 | 85.28 | S76°48'27"W | | | |
| 21 | 22 | 13.58 | N26°48'19"W | | | |
| 22 | 23 | 79.50 | N61°44'58"E | | | |
| 23 | 24 | 13.97 | N31°03'38"W | | | |
| 24 | 25 | 16.11 | S60°58'52"W | | | Along parcel line |
| 25 | 26 | 664.38 | N26°41'16"W | | | To a point along parcel line (400-foot offset downstream of dam) |
| 26 | 27 | 119.61 | N49°02'06"E | | | Along parcel line |
| 27 | 28 | 62.39 | N55°50'38"E | | | Along parcel line |
| 28 | 29 | 9.57 | N55°43'44"E | | | Along parcel line |
| 29 | 30 | 36.38 | N55°45'51"E | | | Along parcel line |
| 30 | 31 | 24.74 | N55°45'28"E | | | Along parcel line |
| 31 | 32 | 43.16 | N71°33'38"E | | | Along parcel line |
| 32 | 33 | 29.91 | N78°51'34"E | | | Along parcel line |
| 33 | 34 | 16.36 | N27°17'06"W | | | Along parcel line |
| 34 | 35 | 222.50 | N56°55'58"E | | | Along parcel line |
| 35 | 36 | 50.01 | S14°45'32"E | | | Along parcel line |
| 36 | 37 | 8.54 | S27°17'04"E | | | Along parcel line |
| 37 | 1 (POB) | 41,155.94 | | | | Along elevation contour 647.08 ft NGVD to 1 (POB) |

RECREATION FACILITY TABLE

| Site ID | Recreation Facility | Latitude | Longitude |
|---------|--|-------------------|-------------------|
| 1 | Van Arnum's Island (Dixon Nature Preserve) | 41° 50' 51.483" N | 89° 28' 33.227" W |
| 2 | Tailwater Fishing Area | 41° 50' 42.481" N | 89° 28' 55.239" W |
| 3 | Canoe Portage Take-Out | 41° 51' 04.664" N | 89° 28' 27.338" W |
| 4 | Canoe Portage Put-in | 41° 50' 38.586" N | 89° 29' 56.772" W |

Recreation Facility Notes:
Site ID 1 - Van Arnum's Island is owned by the Licensee and leased to the Dixon Park District.
Site ID 2 - Tailwater Fishing Area is a FERC-approved Project recreation facility.
Site ID 3 - Canoe Portage Take-Out is a non-project recreation facility and is shown on Map G-1 for reference only.
Site ID 4 - Canoe Portage Put-In is a non-project recreation facility and is shown on Map G-1 for reference only.

SURVEYOR'S STATEMENT

I HEREBY STATE THE PROJECT BOUNDARY DELINEATION FOR THE DIXON HYDROELECTRIC PROJECT AS SHOWN ON THIS EXHIBIT "G" MAP IS DEVELOPED WITHIN REASONABLE MAPPING ACCURACIES AS REQUIRED IN 18CFR4.41. THE DOCUMENTED DIXON PROJECT BOUNDARY LINE WAS ADJUSTED OR ROTATED TO BEST FIT WITH GEOSPATIAL DATA OBTAINED FROM ILLINOIS ON-LINE DATA SOURCES AND WAS NOT FIELD SURVEYED.

JASON NESS

DATE

LICENSEE STATEMENT

I have reviewed the Dixon Hydroelectric Project boundary shown herein. The licensee either owns in fee simple or has the rights necessary or appropriate for the operation of the hydroelectric project. The project boundary lines that are not contour lines were based on GIS parcel information provided by Lee County, Illinois and Public Land Survey System (PLSS) data provided by the Illinois Geospatial Data Clearinghouse.

DAVID FOX

DATE

Map Note:

Metes and bounds project boundary description is based on GIS information. When the project boundary description references a specific corner, that reference shall govern over bearing and distance references in case of conflict.

Unless specifically noted otherwise, Illinois section lines and road network are from the Illinois Geospatial Data Clearinghouse and parcel boundaries are from Lee County, Illinois Assessor's Office. Contour lines generated from LIDAR are from the Illinois Height Modernization (ILHMP) project. These items have not been surveyed by Mead & Hunt, Inc.

ALL PUBLIC ROADS AND ASSOCIATED RIGHTS-OF-WAYS ARE EXCLUDED FROM THE PROJECT.

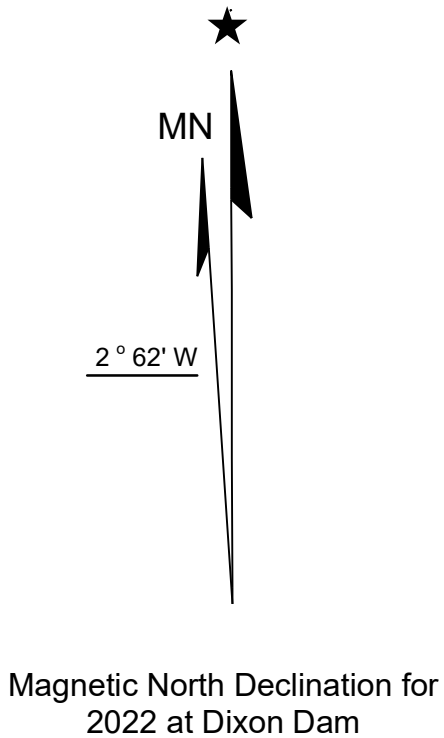

Reference coordinates are in Illinois Stateplane West Zone FIPS 1202, NAD83 (2011).
Coordinate units are in U. S. Survey feet.
Project boundary elevation contour is referenced to NGVD 1929.

EXHIBIT G - 2

STS HYDROPOWER, LLC

DIXON, ILLINOIS

DIXON HYDROELECTRIC PROJECT
FERC PROJECT No. 2446
ROCK RIVER, LEE COUNTY, ILLINOIS
PROJECT BOUNDARY MAP

Mead
& Hunt

SCALE: AS SHOWN
DATE: MAR 2022